

Nasal Spray Pump

Multi-dose Nasal Spray Pump

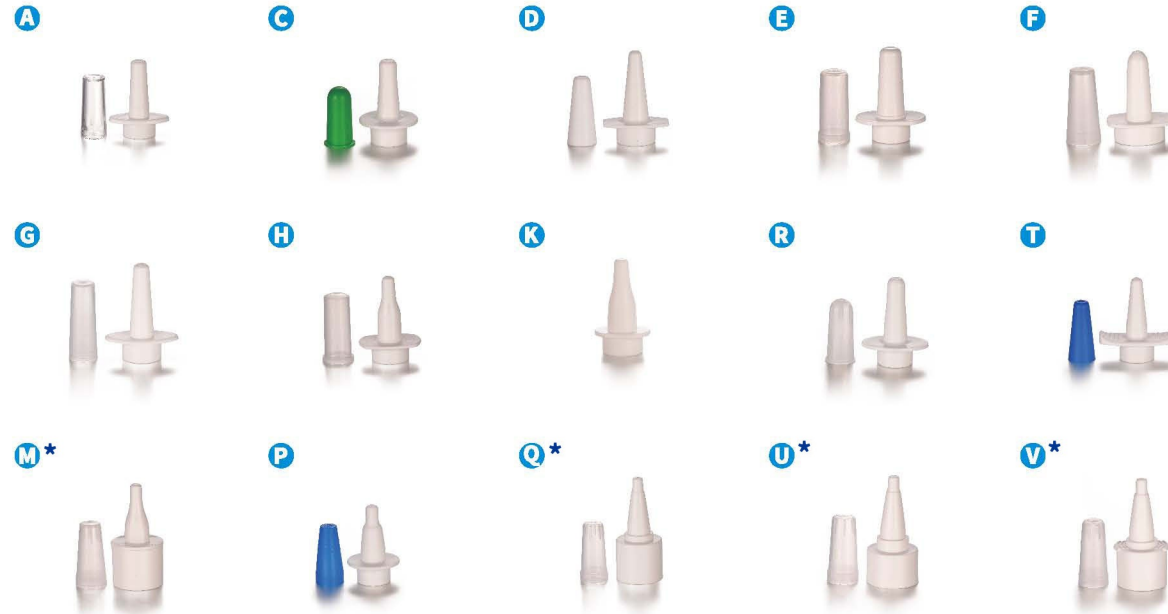

Optional Nasal Actuator



* Crimp on only

Main Parameters:

Dosage: 45mcl to 220mcl

Compatible neck size, 18/410, 18/415, 18GL, 18TE, 18DIN, 20/410, 24/410 for screw-on
20mm for snap-on
20mm for crimp-on

Key Features:

Precise dosage, excellent spray atomization
Universal and modular design, stable performance & anti-clogging
Fully physical & chemical validation, high level microbiological safety
Comply with CP, EP, USP food & drug direct contact regulations
US DMF# 031363

Oral Spray Pump

Multi-dose Oral Spray Pump



Optional Oral Actuator

L



O*



J



I*



SR



LR



3"



N



SF1



SF2



SF3



LF



DP1



* Crimp on only

Main Parameters:

Dosage: 45mcl to 220mcl

Compatible neck size, 18/410, 18/415, 18GL, 18TE, 18DIN, 20/410, 24/410

for screw-on

20mm for snap-on

20mm for crimp-on

Key Features:

Precise dosage, excellent spray atomization

Universal and modular design, stable performance & anti-clogging

Fully physical & chemical validation, high level microbiological safety

Comply with CP, EP, USP food & drug direct contact regulations

US DMF# 031364

Topical spray Pump

Multi-dose Topical Spray Pump

Main Parameters:

Dosage: 45mcl to 220mcl

Compatible neck size, 18/410, 18/415, 18GL, 18TE, 18DIN, 20/410, 24/410 for screw-on
20mm for snap-on
20mm for crimp-on

Key Features:

Precise dosage, excellent spray atomization

Universal and modular design, stable performance & anti-clogging

Fully physical & chemical validation, high level microbiological safety

Comply with CP, EP, USP food & drug direct contact regulations

Optional Topical Actuator



Ear Spray pump

Multi-dose Ear Spray Pumps

Optional Ear Actuator

Sf1



Es1



Sf2



LF

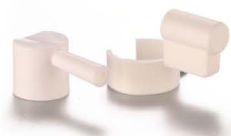

Main Parameters:

Dosage: 45mcl to 220mcl

Compatible neck size, 18/410, 18/415, 18GL, 18TE, 18DIN, 20/410, 24/410 for screw-on
20mm for snap-on
20mm for crimp-on

Key Features:

Precise dosage, excellent spray atomization

Universal and modular design, stable performance & anti-clogging

Fully physical & chemical validation, high level microbiological safety

Comply with CP, EP, USP food & drug direct contact regulations



Closures

Screw on



18/410



18/415



18Din



18GL



18TE

Dosage (mcl)	45	50	65	67	70	78	85	90	100	110	120	130	140	150
	170	180	200	220										



20/410



20/415

Dosage (mcl)	45	50	65	67	70	78	85	90	100	110	120	130	140	150
	170	180	200											



24/410

Dosage (mcl)	100	143	170
--------------	-----	-----	-----

Closures

Snap on



15mm

Dosage (mcl) 80



20mm

Dosage (mcl) 45 | 50 | 65 | 67 | 70 | 78 | 85 | 90 | 100 | 110 | 120 | 130 | 140 | 150 | 170 | 180
200

Crimp on



18mm



20mm/G1



20mm/G2

Dosage (mcl) 45 | 50 | 65 | 67 | 70 | 78 | 85 | 90 | 100 | 110 | 120 | 130 | 140 | 150 | 170 | 180
200

Innovation & Patented Products



Child Resistant Nasal Pump

Key Features:

Comply with 16CFR1700.20

Tamper-evident closure

15ml and 30ml HDPE bottle are available

Invention Patented in China, USA, Europe and Korea



Preservative Free Nasal Pump

Key Features:

Air filter membrane

Air filter compatible with medicine solution

0.14ml dosage available

Invention Patented in China, USA, Europe and Korea



Preservative Free Eye Drop Bottle

Key Features:

Air filter membrane

Passed microbiological challenging test

5ml, 7ml, 10ml volume available